

Discover Prime Happiness

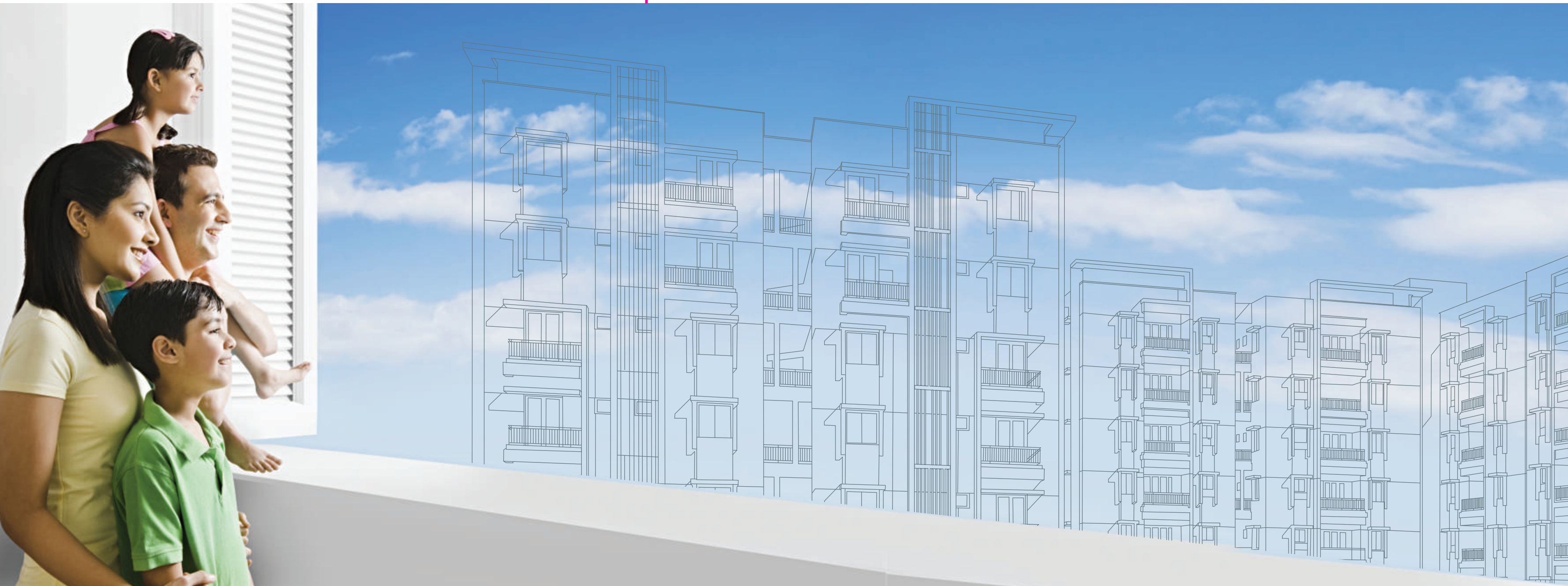



PRIME

Architecture

Spread in a verdant area of around 4 acres

"Vertex Prime" ensures the best quality construction with attention to minute details of elevation and design.

- ♥ 5 towers with 6 level living
- ♥ 284 Apartments of 2 & 3 BHK
- ♥ Sizes vary from 1140 sft to 1470 sft
- ♥ Quality Construction
- ♥ Vaastu Compliant





PRIME

Conveniences



Experience blissfully happy living and a strong sense of joy. Featuring elegantly extensive landscaping and prime conveniences to thrill the whole family Vertex Prime offers contemporary facilities to make every moment of your life meaningful.

- ♥ GHMC Approved Gated Community
- ♥ Remarkable Landscaping
- ♥ Centralized Gas Pipelines
- ♥ Adequate Water Supply
- ♥ Power Back-up
- ♥ Jogging Track
- ♥ Children's Play Area
- ♥ Tot-Lot



Revel & Rejoice with **PRIME**
Amenities



Excitement comes in the form of a fully loaded clubhouse which makes sure that there is never a dull moment. And if all you want to do is just relax, then you can choose the cool confines of the pool.

- ♥ Clubhouse with Modern Amenities
- ♥ Swimming Pool with Changing Rooms
- ♥ A/C Gymnasium
- ♥ Meditation/Yoga Hall
- ♥ Multipurpose Hall with Stage
- ♥ Indoor Games
- ♥ Creche
- ♥ Library
- ♥ Guest Rooms



PRIME Layout



Typical Floor Plan A Block

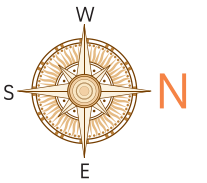

Typical Floor Plan
A Block

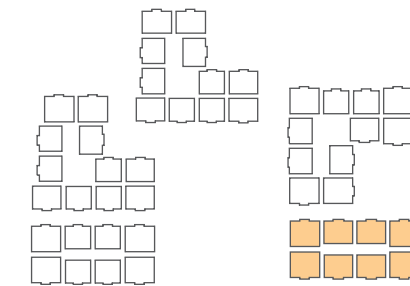

AREA STATEMENT
BLOCK - A

FLAT	Total Area (sft)	Bedroom
1 & 2	1470	3
3 & 4	1280	3
5 & 6	1470	3
7 & 8	1280	3

Typical Floor Plan C Block



Typical Floor Plan
C Block

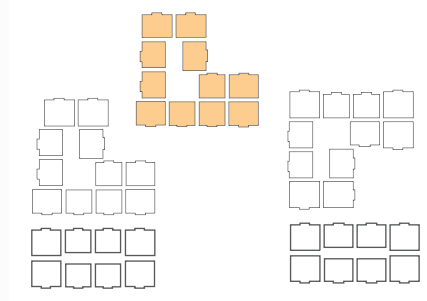

**AREA STATEMENT
BLOCK - C**

FLAT	Total Area (sft)	Bedroom
1	1140	2
2 & 3 & 4	1280	3
5	1140	2
6 & 7	1280	3
8 & 9	1140	2
10	1280	3
11	1140	2

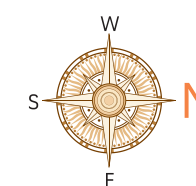

Typical Floor Plan D Block

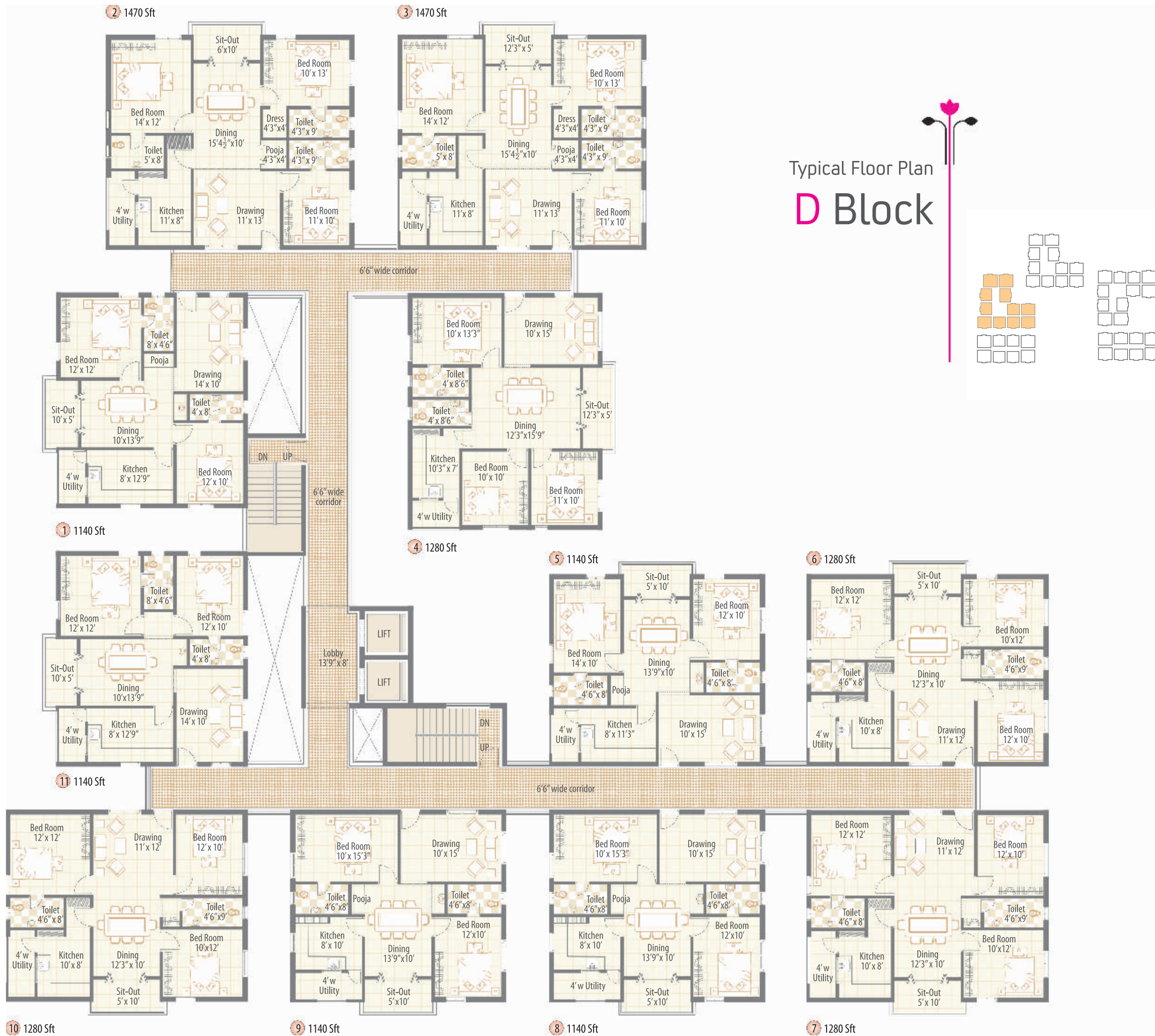

AREA STATEMENT
BLOCK - D

FLAT	Total Area (sft)	Bedroom
1	1140	2
2 & 3	1470	3
4	1280	3
5	1140	2
6 & 7	1280	3
8 & 9	1140	2
10	1280	3
11	1140	2

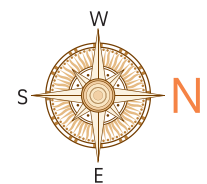

Typical Floor Plan E Block



Typical Floor Plan E Block

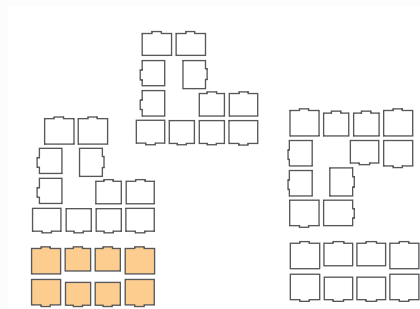

AREA STATEMENT BLOCK - E

FLAT	Total Area (sft)	Bedroom
1 & 2	1470	3
3 & 4	1140	2
5 & 6	1470	3
7 & 8	1140	2

PRIME
Aerial View



SPECIFICATIONS

FRAMED STRUCTURE

RCC framed structure to withstand wind and seismic loads.

SUPER STRUCTURE

Brick masonry in Cement mortar.

PLASTERING (INTERNAL & EXTERNAL)

Double coats cement plaster with sponge finish.

WATER PROOFING

Water Proof cement plaster with brickbats for sunken slabs.

DOORS & WINDOWS

- Main Door : Teak Wood Frame and shutter with teak ply/teak veneer aesthetically designed with melamine polish and designer hardware of reputed make.
- Internal Doors : Teak Wood Frame and flush door shutters with veneer, polish and standard hardware.
- French Doors : Aluminum / Wood frame with glass panel and hardware of reputed make.
- Windows : Aluminum frame fitted with float glass and hardware of reputed make.

PAINTING & POLISHING

- Internal Wall : Premium emulsion paint with roller finishing for both walls and ceilings
- External Wall : Premium Texture Paint
- Polishing : For all door frames and shutters.
- Enamel : For all grills and railings.

Flooring

- In all rooms : Vitrified tiles 2' X 2' with 4" skirting
- Toilets : Acid resistant anti-skid ceramic tiles
- Utility : Anti Skid Ceramic Tiles

CLADDING & DADOING

- Dadoing up to 7' height in all toilets
- Designer tiles up to 2' height above kitchen platform
- Ceramic Tiles upto 3' height in utility / wash area
- Granite Platform with stainless steel sink for kitchen
- Vitrified tiles for corridor flooring
- Marble /Granite for lift wall cladding

ELECTRICAL & COMMUNICATION WORKS

ELECTRICAL

Concealed copper wiring in conduits of standard make for lights, fans and power plug points wherever necessary

- Power outlets for air conditioners in all bedrooms
- Power outlet for Geysers in all bathrooms
- Power plug for cooking range chimney, refrigerators, microwave, mixer grinders in kitchen.
- Plug Points for TV, Computers, etc. wherever necessary.
- 3 Phase supply for each unit and individual meter boards
- MCB & ELCB for each distribution boards of reputed make
- All electrical fittings of reputed brands

COMMUNICATION

Telephone points in master bedroom and living room
Intercom facility connecting all flat, service units and security

CABLE TV

Provision for cable connections in master bedroom and living room

POWER BACK UP

Power back up through Generators

LIFTS

Each block equipped with passenger lifts

WATER SUPPLY, SANITARY & PLUMBING WORK

WATER SUPPLY

ISI mark GI /PPR / PVC piping executed by professional plumbers

TOILETS

All toilets consist of

- EWC with flush tank of reputed make
- Hot and cold water mixer with shower of reputed make.
- Provision for Geyser in all toilets
- All CP fittings of reputed brands

DRAINAGE

ISI mark PVC equivalent sanitary piping. All pumps of reputed make.

GAS SUPPLY

Gas supply through pipes for each flat.



Plot No: 8/B, Nizampet Road, Kukatpally, Hyderabad – 72
Phone : 040- 23056090, 23053942



Plot No. 559, Road No. 92, Phase-III, Jubilee Hills, Hyderabad - 500 033.
Ph: 040-2355 4366/77